

cor light ...

LP13 Satiné ... modular

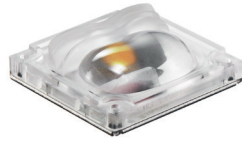

Large area lighting unit

Optimized for open area illumination

- Typical ratio of 4.0 for pole distance to mounting height
- Typical ratio of 3.0 for length of the illuminated field forward to mounting height
- Numerous options for attaching and configuring
- Power rating up to 600 mA, dimmable
- Highest system efficiency
- Sustainable and future-oriented
- Multichip technology
- ESD-protection
- CRI 70 min

Lighting unit structure

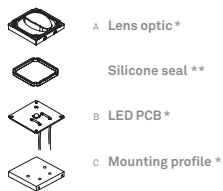

* Specific article number ** inclusive

A Lens optic

→ Article no. 3 03 0006 01

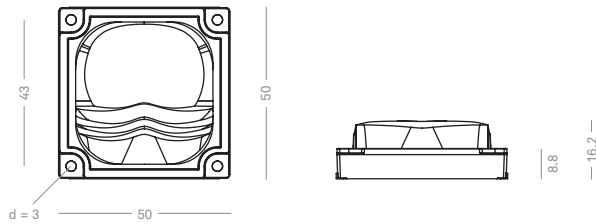

Combinable



Rotable / in steps of 90° (exception: power outlet position)

Light distribution

Polar diagram

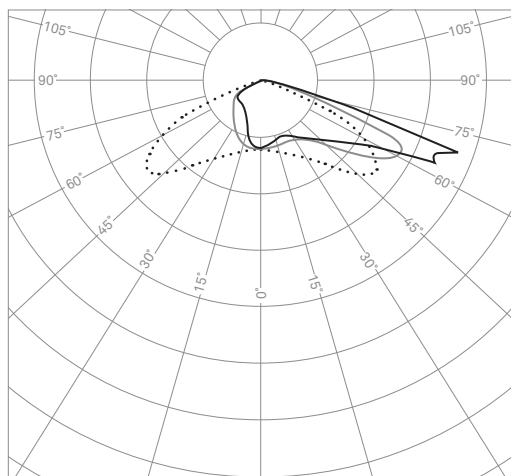

... C0-C180 — C30-C210 - - C90-C270

Illuminance distribution

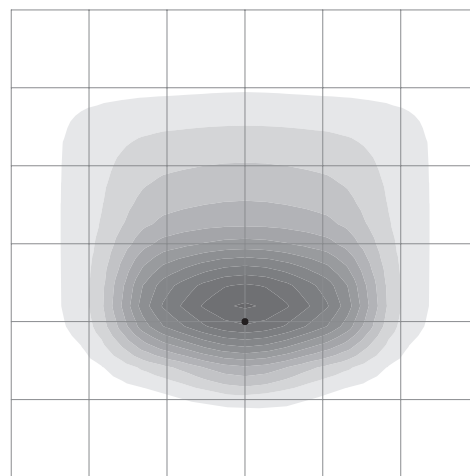

● ● Mounting height

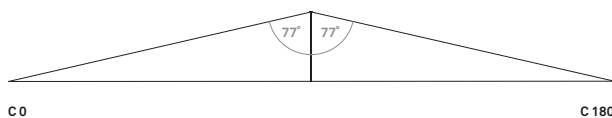

C0

C180



C270

C90

B LED PCB

Variant 01 (power outlet underneath): IP67 rating in combination with mounting profile
Variant 02 (power outlet on side): IP67 rating

1 LED PCB

V_F 12 V

→ Article no. see table below + variant



Variant 01



Variant 02

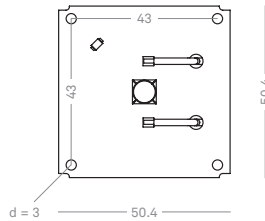

Article no.	Colour temperature (K) (typical)	No. of LED	Power (W)				Lumen (lm) (25°C ambient temperature including optical system loss)				Luminous efficacy of LED module (lm/W); (25°C ambient temperature including optical system loss)				Life time (h)
			300 mA	400 mA	500 mA	600 mA	300 mA	400 mA	500 mA	600 mA	300 mA	400 mA	500 mA	600 mA	
3 02 0001 __	3000	1	3,3	4,4	5,5	6,6	398	505	602	690	120,7	114,7	109,3	104,4	50000
3 02 0002 __	4000	1	3,3	4,4	5,5	6,6	426	541	645	739	128,9	122,8	117,0	111,8	50000
3 02 0003 __	5700	1	3,3	4,4	5,5	6,6	426	541	645	739	128,9	122,8	117,0	111,8	50000

2 LED PCB

V_F 23 V

→ Article no. see table below + variant

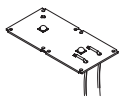

Variant 01

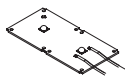

Variant 02

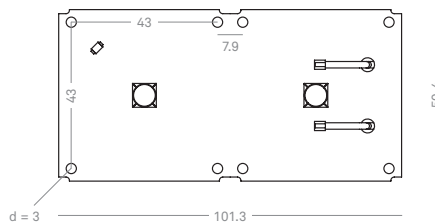

3 02 0004 __	3000	2	6,6	8,8	11,0	13,2	797	1011	1205	1380	120,7	114,7	109,3	104,4	50000
3 02 0005 __	4000	2	6,6	8,8	11,0	13,2	851	1083	1289	1479	128,9	122,8	117,0	111,8	50000
3 02 0006 __	5700	2	6,6	8,8	11,0	13,2	851	1083	1289	1479	128,9	122,8	117,0	111,8	50000

4 LED PCB

V_F 47 V

→ Article no. see table below + variant

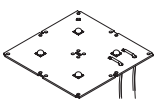

Variant 01

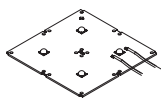

Variant 02

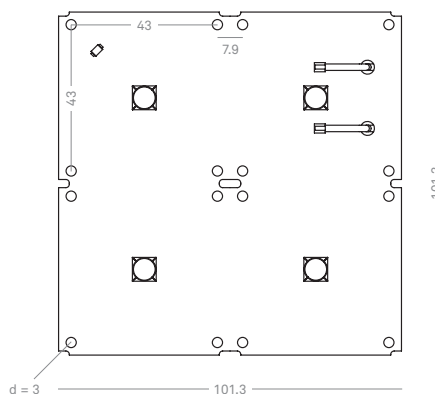

3 02 0007 __	3000	4	13,2	17,6	22,0	26,5	1593	2021	2410	2761	120,7	114,7	109,3	104,4	50000
3 02 0008 __	4000	4	13,2	17,6	22,0	26,5	1702	2165	2579	2957	128,9	122,8	117,0	111,8	50000
3 02 0009 __	5700	4	13,2	17,6	22,0	26,5	1702	2165	2579	2957	128,9	122,8	117,0	111,8	50000

→ Article no. **example**
4 LED PCB with power outlet underneath = **3 02 0007 01**

Note: the product code is complete only if the variant is indicated.

Prerequisite for compliance of the data sheet specifications is the observation of temperature limits
Tc < 80°C @ 600mA and 25°C ambient temperature
Temperature measuring unit available

C Mounting profile (optional)

- Can be used for lighting units with PCBs of variant 01 and 02

1 mounting profile *

→ Article no. 40 20000 30

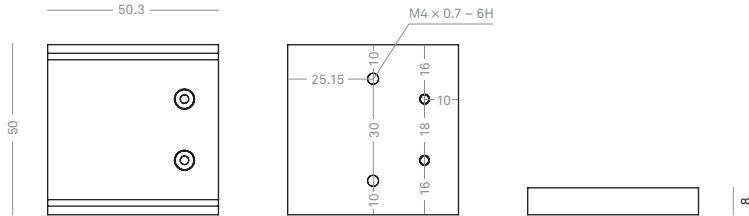

2 mounting profile *

→ Article no. 40 20000 20

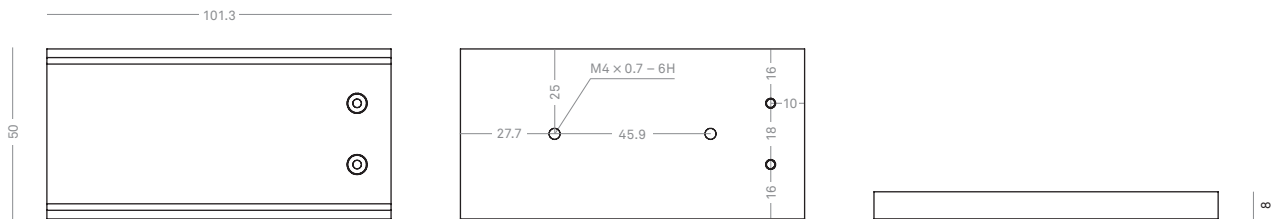
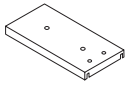

4 mounting profile *

→ Article no. 40 20000 40

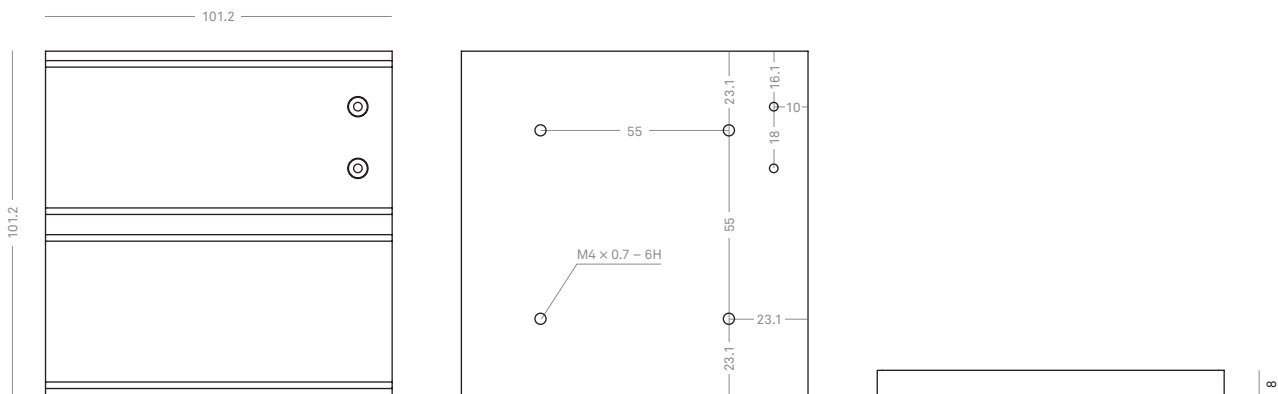
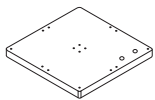

* Recommended mounting screws included: BN 20165 – M 2.5 x 12 mm

Assembly and maintenance instruction on www.corlight.com